

Dane aktualne na dzień: 16-07-2025 08:01

Link do produktu: <https://www.sklep.rai-bud.pl/lancuch-sieczkarnia-claas-jaguar-54-ogniwa-9129931-9116692-50-wzmacniany-p-732.html>



## Łańcuch sieczkarnia Claas Jaguar 54 ogniwa, 912993.1 911669.2-50 WZMACNIANY

|                  |                     |
|------------------|---------------------|
| Cena brutto      | <b>497,64 zł</b>    |
| Cena netto       | <b>404,59 zł</b>    |
| Dostępność       | <b>Dostępny</b>     |
| Czas wysyłki     | <b>Natychmiast</b>  |
| Numer katalogowy | <b>912993.1</b>     |
| Kod producenta   | <b>190190020-54</b> |

### Opis produktu



**Łańcuch sieczkarnia Claas Jaguar 54 ogniwa, 912993.1 911669.2-50 WZMACNIANY S55V**

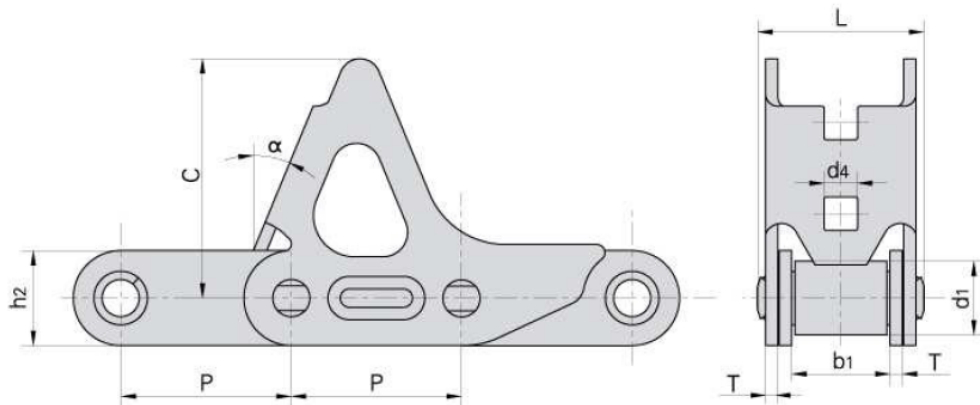

| Donghua<br>Chain No.<br>Donghua<br>Ketten Nr. | Pitch          | Roller<br>diameter                   | Width<br>between<br>inner plates | Pin<br>length            | Plate<br>dimension             |     |    |     |          | Ultimate<br>tensile<br>strength | Weight<br>per<br>meter |
|---|----------------|--------------------------------------|----------------------------------|--------------------------|--------------------------------|-----|----|-----|----------|---------------------------------|------------------------|
|   | <i>Teilung</i> | <i>Rollen-<br/>durch-<br/>messer</i> | <i>Innere<br/>Breite</i>         | <i>Bolzen-<br/>länge</i> | <i>Laschen-<br/>abmessugen</i> |     |    |     |          | <i>Min.<br/>Bruchkraft</i>      | <i>Gewicht</i>         |
|   | P              | d1<br>max                            | b1<br>min                        | L<br>max                 | h2<br>max                      | T   | C  | d4  | $\alpha$ | Q<br>min                        | q                      |
|   | mm             | mm                                   | mm                               | mm                       | mm                             | mm  | mm | mm  |          | kN                              | kg/m                   |
| 55VDF1-CPEF                                   | 41.4           | 17.9                                 | 22.5                             | 39.7                     | 23.0                           | 3.0 | 58 | 8.1 | 22.5°    | 50/11248                        | 3.68                   |